

A.L.P. APPROVALS

FEDERAL AVIATION ADMINISTRATION

CONDITIONALLY APPROVED

PER LETTER DATED: April 23, 2024

NAME: Jared Wingo

SIGNATURE: 

TITLE: (Acting) Community Planner

DATE: June 24, 2024 | 16:10 PDT

HELENA AIRPORTS DISTRICT OFFICE

AIRSPACE APPROVAL

A.L.P. AIRSPACE APPROVAL DATE: April 23, 2024

CASE NO.: 2024-ANM-1756-NRA

EXISTING BUILDING INVENTORY			EXISTING BUILDING INVENTORY		
BUILDING NO.	DESCRIPTION	ELEVATION (FT MSL)	BUILDING NO.	DESCRIPTION	ELEVATION (FT MSL)
0-3	Electrical Vault	4,142.7	6-3	Private Hangar	4,125.7
0-4	Maintenance Building	4,143.5	6-6	Private Hangar	4,122.1
0-5	Airport Terminal	4,153.2	6-9	Private Hangar	4,130.7
0-6	FAA Offices	4,138.9	6-11	Private Hangar	4,132.1
0-7	Control Tower	4,198.1	6-12	Private Hangar	4,132.4
0-8	Well	4,104.8	7-1	Private Hangar	4,126.0
0-10	Pump House	4,111.9	7-2	Private Hangar	4,124.5
0-11	Shed	4,109.4	7-3	Private Hangar	4,123.5
1-1	FBO Facility	4,146.6	7-6	Private Hangar	4,124.5
1-2	Private Hangar	4,135.7	7-7	Private Hangar	4,134.8
1-3	Private Hangar	4,137.5	7-8	Private Hangar	4,133.1
1-4	Private Hangar	4,131.8	7-9	Private Hangar	4,131.7
1-5	Private Hangar	4,129.8	7-10	Private Hangar	4,127.7
1-6	Private Hangar	4,129.7	8-2	Private Hangar	4,125.7
2-1	Private Hangar	4,145.5	8-3	Private Hangar	4,128.9
2-2	Civil Air Patrol	4,137.5	8-4	Private Hangar	4,130.7
3-1	Private Hangar	4,140.0	8-5	Private Hangar	4,132.5
3-2	Private Hangar	4,136.1	8-6	Private Hangar	4,128.3
4-1	Private Hangar	4,136.0	8-7	Private Hangar	4,127.0
4-2	Private Hangar	4,134.8	8-8	Private Hangar	4,125.8
4-5	Private Hangar	4,124.4	8-10	Private Hangar	4,130.6
4-7	Private Hangar	4,130.0	8-11	Private Hangar	4,122.3
4-8	Private Hangar	4,130.1	8-12	Private Hangar	4,125.7
4-9	Private Hangar	4,131.2	8-13	Private Hangar	4,123.7
4-11	Private Hangar	4,129.3	8-16	Private Hangar	4,121.7
4-15	Private Hangar	4,135.8	9-1	Rental Car Wash Facility	4,130.9
5-1	Private Hangar	4,129.7	9-2	Army Reserve	4,131.9
5-2	Private Hangar	4,123.3	9-3	FBO Fuel Farm	4,113.6
5-3	Private Hangar	4,131.5	9-4	Rental Car Wash Facility	4,125.4
5-4	Private Hangar	4,122.8	9-5	Rental Car Wash Facility	4,124.3
6-1	Private Hangar	4,127.7	10-2	Private Hangar	4,154.5
6-2	Private Hangar	4,133.7	10-3	Private Hangar	4,162.6

EXISTING BUILDING INVENTORY			EXISTING BUILDING INVENTORY		
BUILDING NO.	DESCRIPTION	ELEVATION (FT MSL)	BUILDING NO.	DESCRIPTION	ELEVATION (FT MSL)
10-4	Private Hangar	4,164.1	10-15	BLM Facility	4,153.9
10-5	Private Hangar	4,161.5	10-7	Avionics Shop	4,129.3
10-8	Private Hangar	4,156.1	11-1	SRE Facility	4,144.8
10-9	Private Hangar	4,156.7	11-2	Cargo Facility	4,139.7
10-10	ARFF Building	4,157.3	13-1	Private Hangar	4,132.8
10-11	Private Hangar	4,155.2	13-2	Private Hangar	4,132.0
10-12	Private Hangar	4,123.8	13-3	Private Hangar	4,139.7
10-13	Private Hangar	4,148.2	13-14	Private Hangar	4,132.3

FUTURE BUILDING INVENTORY		
BUILDING NO.	DESCRIPTION	ELEVATION (FT MSL)
F1	ARFF Building	TBD
F2	Future Hangar	TBD
F3	Future Hangar	TBD
F4	Future Hangar	TBD
F5	Future Hangar	TBD
F6	Future Hangar	TBD

Note: Buildings in red to be removed.

	LEGEND	
	EXISTING	FUTURE
Aviation Authority Property Line		
Object Free Area (OFA)		
Runway Safety Area (RSA)		
Obstacle Free Zone (OFZ)		
Building Restriction Line (BRL)		
Runway Visibility Zone (RVZ)		
Runway Protection Zone (RPZ)		
Taxiway Safety Area (TSA)		
Navaid Critical Areas		
Roads		
Contours (Major Minor)		
Fence Line		
Airfield Pavement		
Demolition		
On-Airport Buildings		
Off-Airport Buildings		
High Line Canal		
Water Feature		
Leasable Area		
Off-Airport Property Control		
Localizer (LOC)		
Glide Slope (GS)		
Survey Monument		
Runway Visual Range (RVR)		
Windsock		
Airport Reference Point (ARP)		
Runway End Identifier Lights (REIL)		
Precision Approach Path Indicator (PAPI)		
Building Number		
Vehicle Parking		
Helipoint Touchdown and Liftoff Area (TLOF)		
Helipoint Safety Area		
Helipoint Protection Zone		

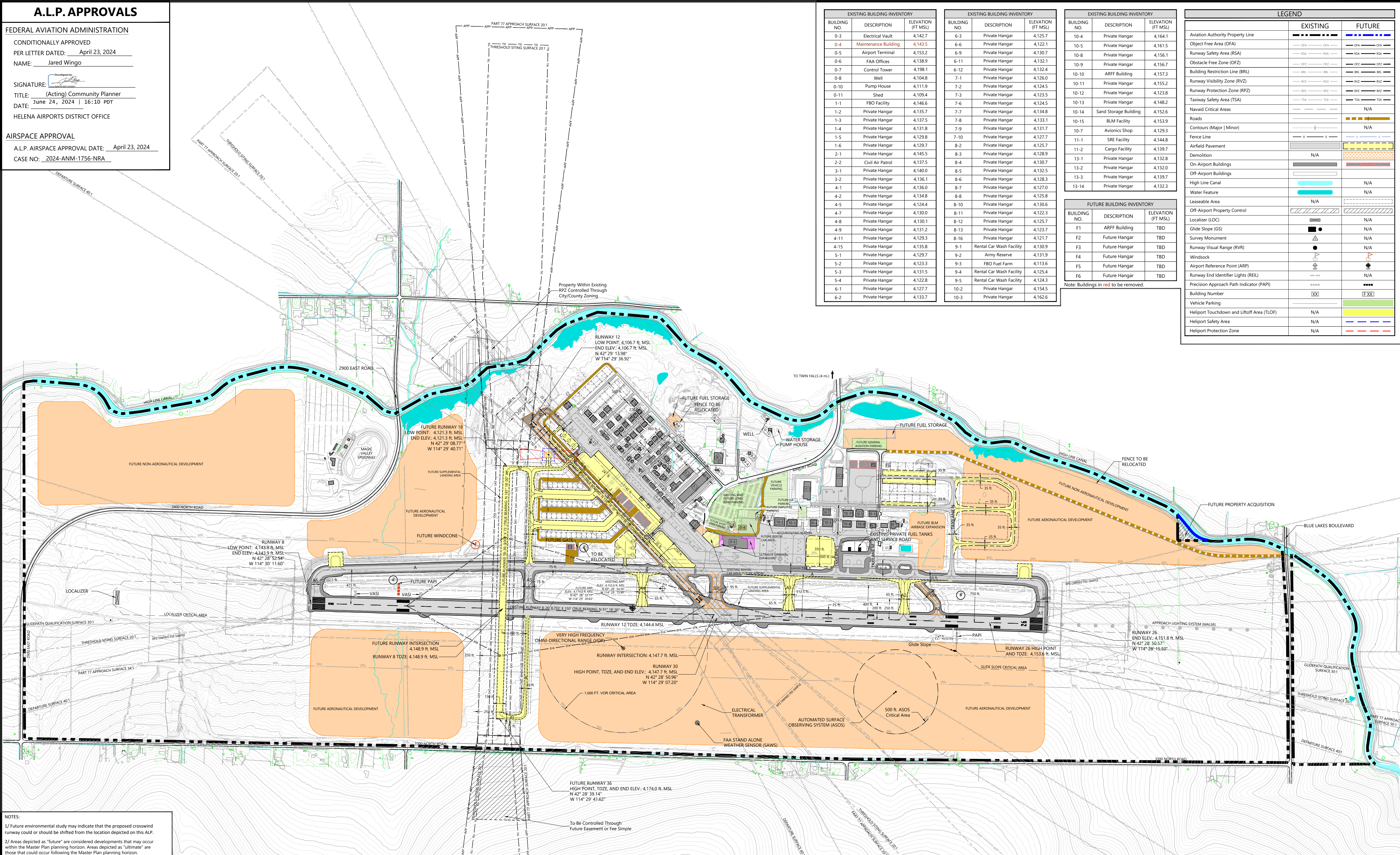

NOTES:

- Future environmental study may indicate that the proposed crosswind runway could or should be shifted from the location depicted on this ALP.
- Areas depicted as "future" are considered developments that may occur within the Master Plan planning horizon. Areas depicted as "ultimate" are those that could occur following the Master Plan planning horizon.



In Association With:

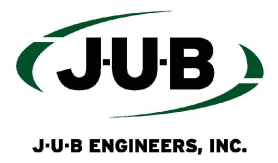

JUB ENGINEERS, INC.





JOSLIN FIELD
MAGIC VALLEY REGIONAL AIRPORT
TWIN FALLS, IDAHO

EXISTING AND FUTURE AIRPORT LAYOUT PLAN

FAA DISCLAIMER:
The contents do not necessarily reflect the official views or policy of the FAA. Acceptance of this plan by the FAA does not in any way constitute a commitment on the part of the United States to participate in any development depicted therein nor does it indicate that the proposed development is environmentally acceptable in accordance with appropriate public laws.

APPROVED BY AIRPORT SPONSORS:

Name: Ruth Pierce
Signature: 
Title: Mayor, City of Twin Falls
Date: June 18, 2024 | 14:26 PDT

Name: Don Hall
Signature: 
Title: Commissioner, County of Twin Falls
Date: June 24, 2024 | 14:28 PDT

NO.	DATE	BY	REVISION HISTORY	
			DESCRIPTION	APPD.

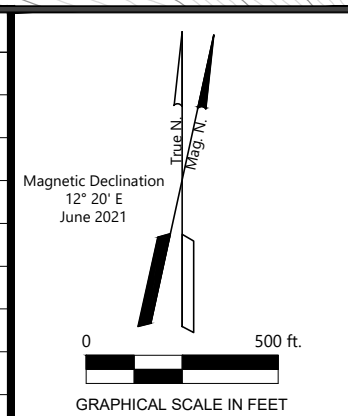

DRAWN BY: AHN
CHECKED BY: JNB
PREPARED BY:
Ricondo & Associates, Inc.
DATE: OCTOBER 27, 2023
SHEET 2